



Helpful Tips

- ★ Protein skimmers only work in saltwater. A steady specific gravity of 1.023-1.025 is recommended.
- ★ It is recommended that the sump water level stays stable at all times. The use of dedicated baffles or auto top off unit allows for more stable filtration from the protein skimmer.
- ★ Never adjust a skimmer after servicing the aquarium or feeding.
- ★ Skimmer pumps are normally louder during the first 2-3 weeks until a bacterial coat lubricates the rotor.



Safety

- Never allow the skimmer pump to run dry.
- Do not insert/pull the power plug with wet hands.
- Only clean the skimmer with vinegar and water.
- When servicing the skimmer please remove the plug from the power socket first.
- Must be used with intended power source only.



Warranty - One (1) year warranty on pump and skimmer body.

IceCap is not responsible for consequential damages arising from installation or use of this product. IceCap warrants the pump to be free from defects in material and workmanship under normal use and conditions for the warranty period from the date of purchase. CoralVue's liability under this warranty shall be limited to repairing or replacing at CoralVue's discretion, without charge. CoralVue will not be liable for any cost of removal, installation, transportation, or any other charges which may arise in a warranty claim.

NOTE: This warranty is void if the product is damaged through abnormal operating conditions, accident, abuse, misuse, unauthorized alteration or repair. This warranty is non-transferable. Consumable spare parts are not applicable to the warranty.



Find us on:



BLOG.CORALVUE.COM

*IceCap reserves the right to change/modify this product without notice.

Need help...Visit
coralvue.com/support



Thank you for
purchasing the
IceCap K2
Protein Skimmer.



In order to save on unnecessary waste with elaborate printed documents that no one reads, we have assembled online guides and video tutorials that cover the basic essentials of how to assemble, setup and operate your new skimmer.



Please fill out the product registration form online at:
coralvue.com/register

K2

PROTEIN SKIMMER



K2 -50

QUICK START GUIDE

PLEASE READ
BEFORE INSTALLING

Parts & Assembly Diagram

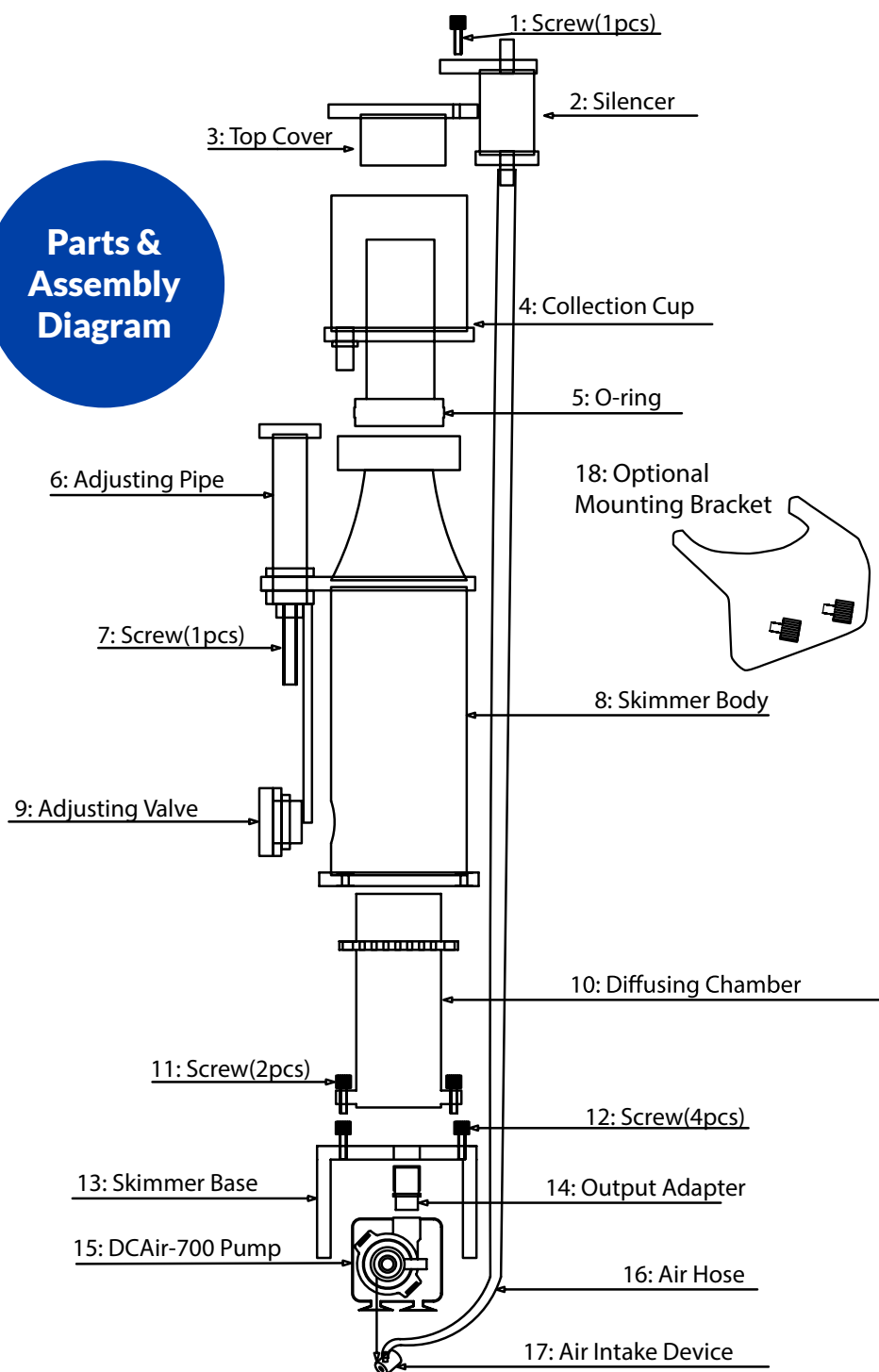

1

Assemble Accordingly

Locate, inspect and identify all components supplied with your new protein skimmer. Please refer to the parts and assembly diagram.

2

Install in Sump

Carefully install the skimmer in your sump at the suggested water depth. The optional mounting bracket can be used to suspend the the skimmer along side of sump. With the output valve completely open, plug the skimmer pump power plug into electrical socket.

3

Operating Your Skimmer

To tune the skimmer to your aquarium, simply close the output valve by turning it counter clockwise until you retain pea size bubbles at the point where the collection cup mounts to the skimmer body. Allow the skimmer to acclimate to the new setting for 24hrs or more before making any further adjustments. The more closed the output valve becomes the wetter the collection will become.

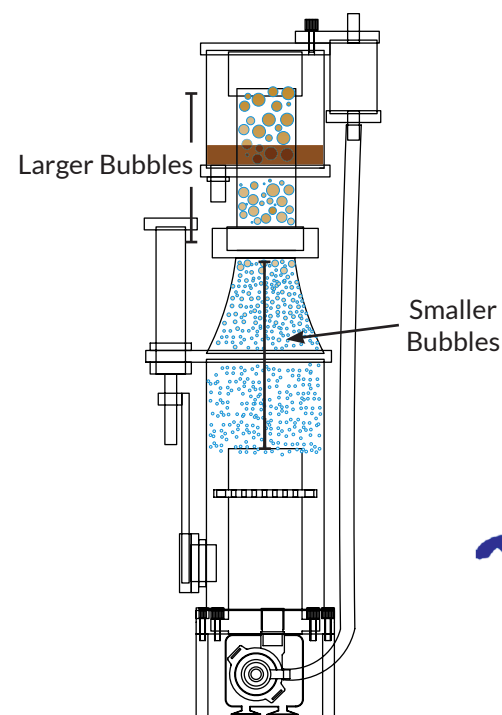

WARNING: Do not attempt dialing in a protein skimmer any sooner than 2 weeks. The wetter the collection (more closed the valve is) the greater chance for the skimmer to overflow.

Suggested Water Height

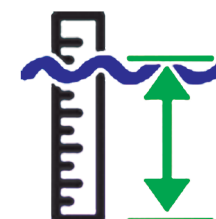

6 - 9in