



DIGITAL POCKET TESTER SALINITY/TEMP

Parts



Calibration



Calibrate Monthly with Regular Use or When High Accuracy is Required

Press the CAL button for 3 seconds to enter calibration mode. Immerse the clean sensor 1.5in into 35.00ppt calibration solution. Wait till the LCD window lights up with 35.00ppt displayed indicating the calibration has been set. Rinse tip with fresh water and begin testing.

Battery Replacement

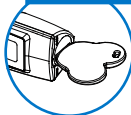

Use coin to
remove cover

DISCONTINUE USE if the **LOW** icon is displayed. Replace batteries to retain accuracy.

- Remove battery cover counterclockwise to "open" and take out batteries
- Replace with 2 new AAA batteries "+" pole direction outward
- Turn the battery cover clockwise to "close"

WARNING: To prevent damaging the meter, pay attention to the "+", "-" pole of batteries

USER INSTRUCTIONS

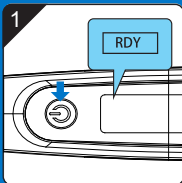

Press power button to turn ON meter
(**RDY** icon flash)

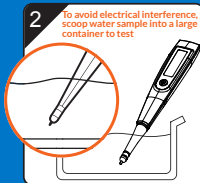

Fully submerge tip in sample and keep probe 1" clear from any surface

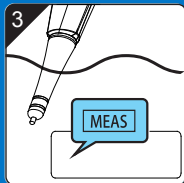

Pen will automatically begin test
(**MEAS** icon flash)



An audible alarm will indicate when the test is complete

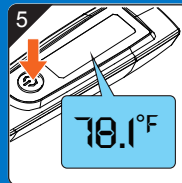

Press power button to cycle between SG, PPT and temp (°F)

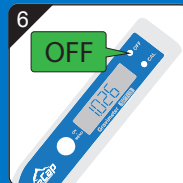

Press OFF button to power off

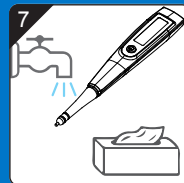

Rinse tip with fresh water, then pat dry after each test and before storage