

A200 IPU



Product description

The innovative Abyzz A200 pump with its titanium impeller consists of a powerful and programmable driver and a sine-wave controlled, three-phase synchronous pump. The efficiency of the motor is more than 90%, which, along with the fact that you can adjust the speed to meet your performance requirements, makes it an energy-saving solution.

The integrated bearing flushing provides optimum protection against calcination and, in conjunction with the silicon carbide bearings and special hard metal shaft, ensures low-maintenance operations. All materials used are designed to have a long lifetime and meet the highest requirements and quality standards. This product is developed and manufactured in Germany by venotec.

Special features

- Variable speed range (0.0 - 100.0%)
- Precise speed adjustment in steps of 0.1%
- Integrated programming to generate waves, bursts and random flow patterns with additional **BOOSTMODE** to override actual programming (MCFS - Menu Controlled Flow Sequencer)
- Comprehensive safety functions, such as dry run warning, temperature alert, overcurrent protection, speed zero alert)
- Soft startup
- Auxillary port for peripheral devices (e.g. interfacing to external controllers)
- High quality IP65 motor cable connector
- Low-noise operation
- Choice of 3m or 10m cable length
- Multicolor background LC display
- Splashwaterproof driver (IP65)
- Wide range input with active power factor correction
- Optimized heat sink design

Applications

- Freshwater and seawater aquaristics
- Pond filter systems
- Creeks
- Water features
- Commercial applications

Technical data

The pump pipes can be immersed or mounted in a dry position. Please note that this pump is not self-priming and thus has to be mounted under water level.

Maximum flow rate	: 17.000l/h (4,500gph)
Rated flow rate	: 14.500l/h (3,800gph)
Pump ambient temp.	: 1...50°C (34...122°F)
Driver ambient temp.	: 0...30°C (32...86°F)
(without additional cooling)	
Max. discharge speed	: 5,8m/s (19ft/s)
Delivery height	: 8,8m (28.8ft)
Power consumption	: 4...200W
Operating voltage	: 100...240V~
Operating frequency	: 50...60Hz
Maximum operating pressure	: 1,2bar (17.4psi)
Maximum immersion depth	: 2m (6.5ft)
Pump cable length	: 3/10m (10/30ft)
Inlet/outlet connections (metric)	: 50/40mm
(suitable for PVC/AVB adhesive fittings, imperial adapters available)	

Characteristics

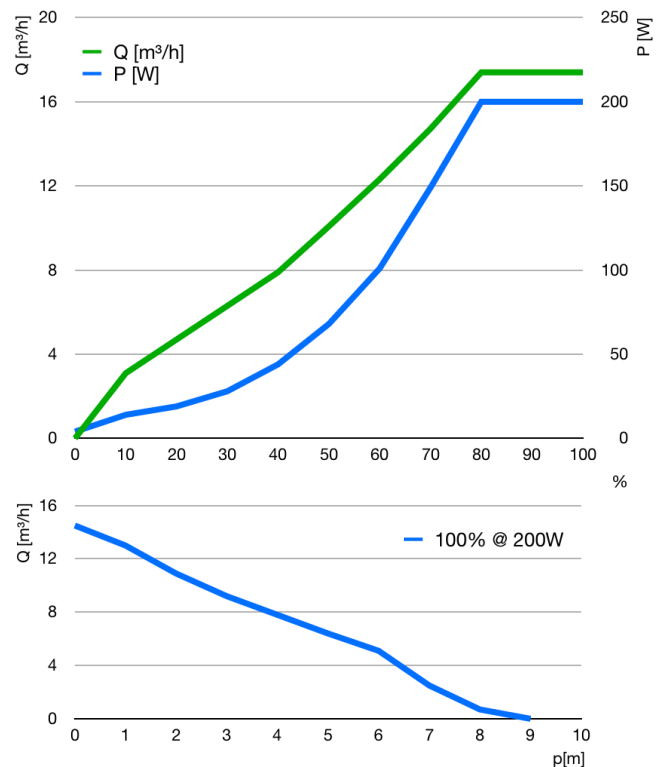

Dimensions of Pump

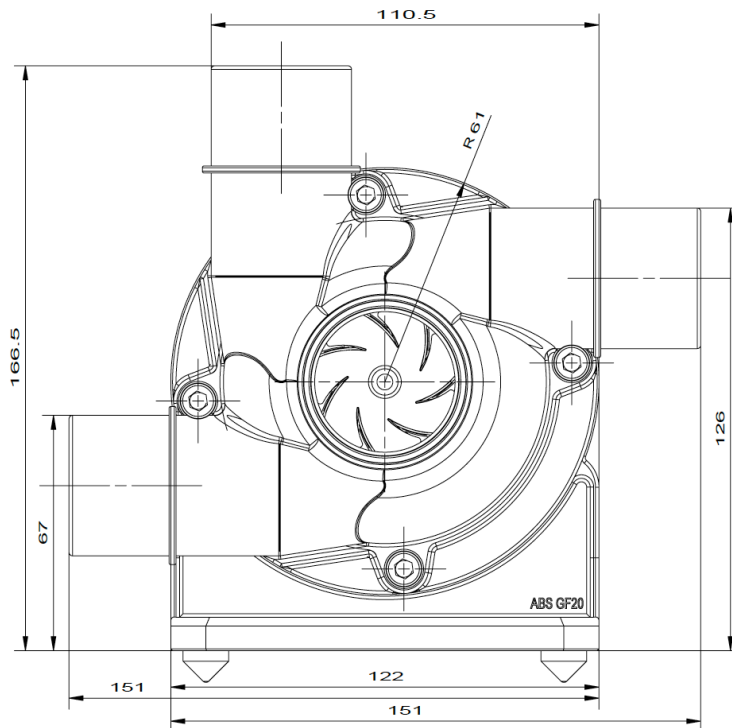

Scope of delivery

- Abyzz A200 pump and IPU driver
- Mains cable (1.5m)
- Operating manual

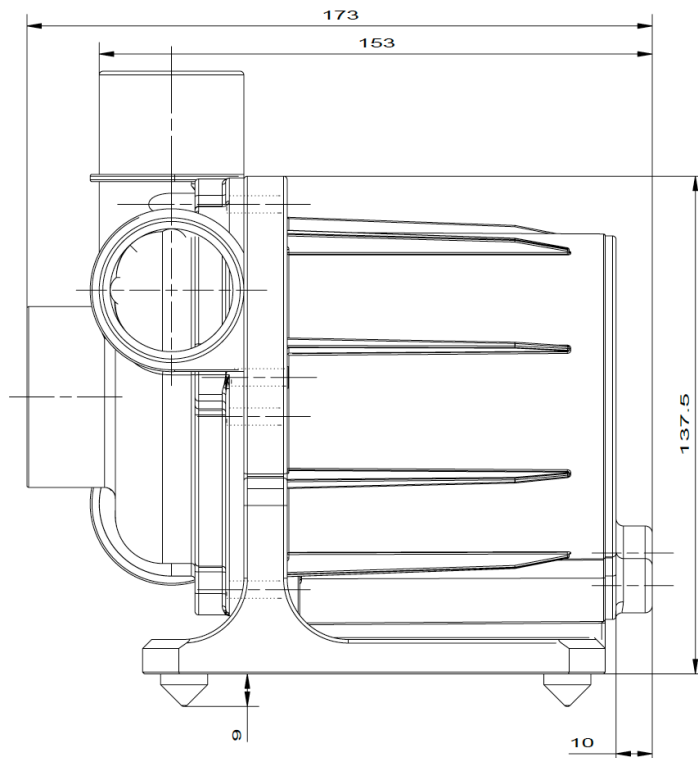

(All dimensions in mm)

We reserve the right to make technical changes.