

X1 PRO 2

Dosing Pump

Quick Start Guide

A0 12/19



Kamoer Fluid Tech (Shanghai) Co., Ltd.

www.kamoer.net

Know X1 PRO 2

X1 PRO 2 is a single-channel intelligent dosing pump with WIFI remote function, mainly used to add the various elements needed for marine life growth, such as calcium, magnesium, KH booster, trace elements, etc. to marine life cylinder timing, quantitative and accurate. The automation of X1 PRO 2 can greatly reduce the amount of manual added work, but also avoid manual addition caused by leakage, adding excessive or insufficient errors.



- | | |
|--------------------------|-----------------|
| 1.Liquid inlet | 2.Liquid outlet |
| 3.Power/status indicator | 4.KXF pump head |
| 5.Reset button | 6.Hanging hole |
| 7.DC12V power input | 8.Power output |

Download app

1. Scan the box or the QR code below and find the app download for the icon below.



iOS



Android

2. Apple users enter the App Store, Android users enter the Baidu App Store, search for "Kamoer Remote" and find the corresponding icon app download.

Note: This app supports iOS 9.1 and above versions of Apple devices, Android 4.4 and above versions of Android devices.

Register account

Open the app, select the phone registration or email registration method, and follow the App prompt to complete the account registration.

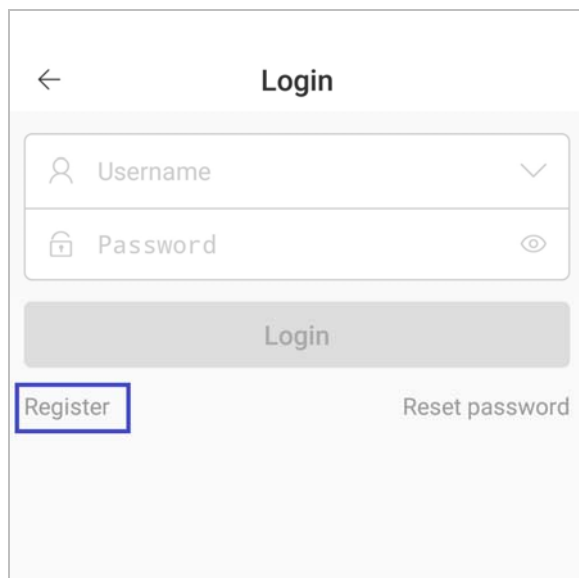
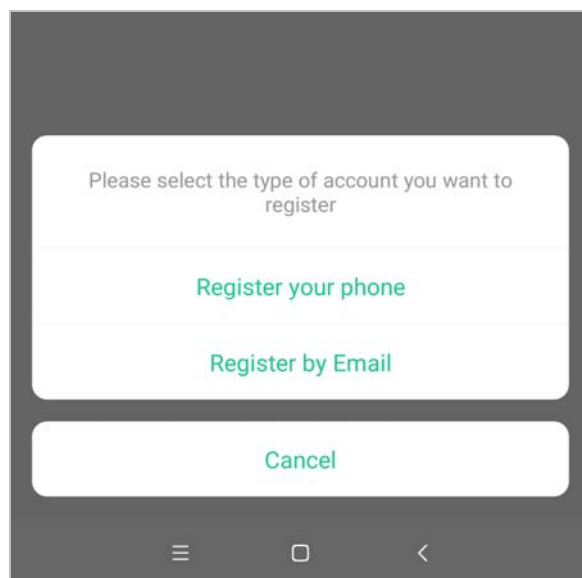
A screenshot of the app's login and registration screen. It features a 'Login' title with a back arrow. Below are input fields for 'Username' and 'Password', each with a dropdown arrow and an eye icon respectively. A 'Login' button is positioned below the password field. At the bottom left, a 'Register' button is highlighted with a blue border, and at the bottom right, there is a 'Reset password' link.A screenshot of the registration selection screen. It displays the text 'Please select the type of account you want to register'. Below this text are two green buttons: 'Register your phone' and 'Register by Email'. At the bottom, there is a white button with the text 'Cancel'. The screen has a dark grey background and a standard Android navigation bar at the bottom.

View Tutorial

Click the icon in the upper left corner of the device list page to enter the user page, click "Tutorial" on the page to enter the product selection page, select "X1 PRO 2" to view the tutorial, the tutorial includes the user manual and FAQ.

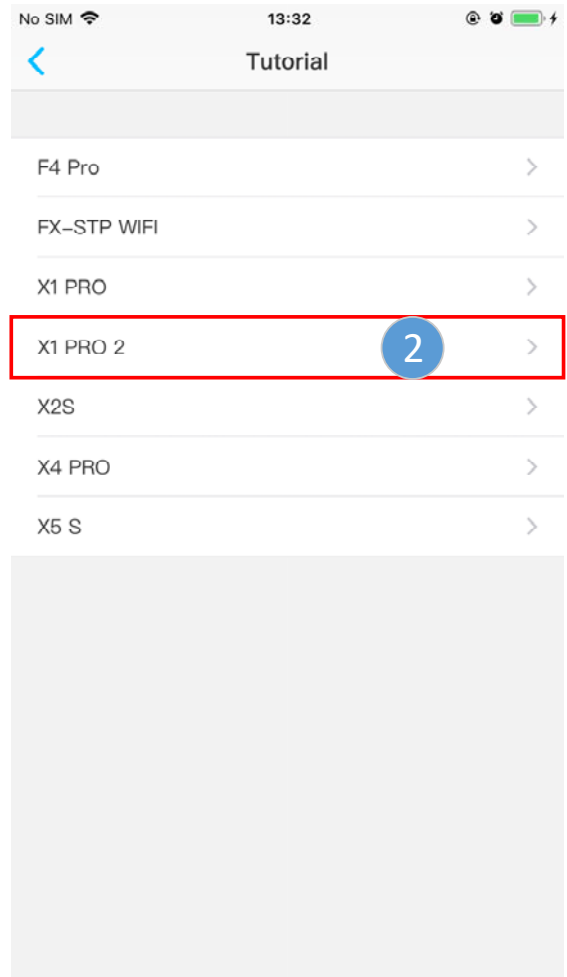
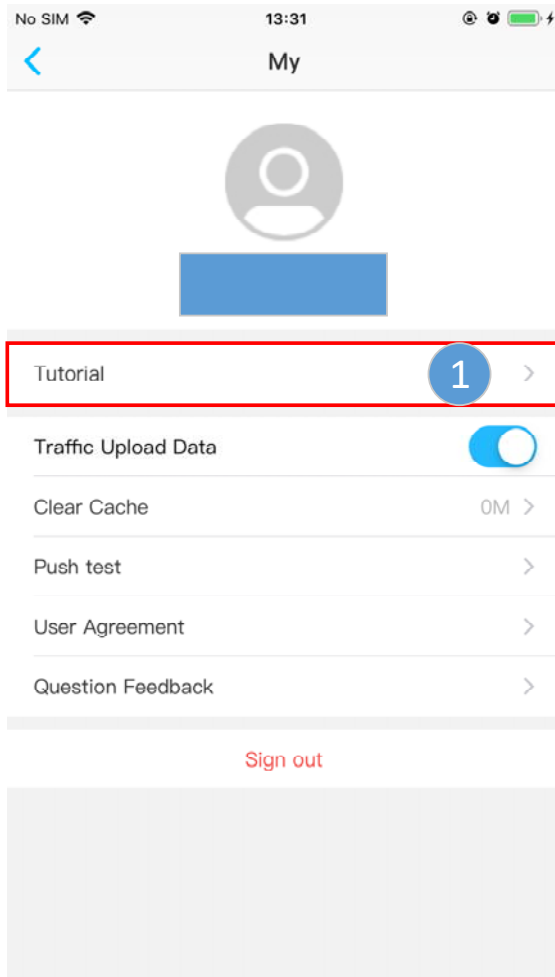

Indicator

Indicator	Status	Description
Status indicator (Blue)	On	Connected to the cloud via router
	Off	Disconnected from router
	Fast flashing	Network configuration mode, at this time, the app can configure the X1 PRO 2 to access the router
	Slow flashing	Disconnect from the cloud
Power indicator (Red)	On	Powered on
	Off	No power on or a power failure

Note: When the blue status indicator is on or flashing, the red power indicator is off.

Connect X1 PRO 2 to the cloud

The dosing pump is powered on for the first time after the box is open, the status indicator (Blue) flashes slowly, at which point will require the use of an app to connect the dosing pump to the cloud via a wireless router. Follow the steps below:

1. Ensure that the wireless router is connected to the Internet;
2. Press and hold the Reset button on the front panel for more than 4 seconds then release;
3. Wait for the blue status indicator to become a fast flashing state, at this time the dosing pump has entered the network configuration mode;
4. Mobile phone connected to the wireless router 2.4G WIFI hotspot (device does not support 5G WIFI, cannot use 5G WIFI hotspot);
5. Open the App, log in with the registered account, click the “+” icon in the upper right corner, select “Add Device”, select “X1 PRO 2” in the list of supported devices, and then follow the App prompt to complete the connection router operation.
6. After the connection is successful, the App will prompt the connection to be successful. At this time, the status indicator (Blue) is on, indicating that the dosing pump is connected to the cloud, and the user has also completed the binding with the dosing pump.

Binding X1 PRO 2

There are two ways for user to bind the X1 PRO 2.

Method 1: Bind the dosing pump through the network configuration described above.

Method 2: If the dosing pump is connected to the cloud through the router, the mobile phone can be connected to the wireless router, and the App will scan and display the locally available dosing pump. The user directly clicks the "Bind" button on the right side of the dosing pump to complete the binding.

Unbind

On the device list page, press and hold the corresponding dosing pump icon, the "Remove" icon pops up at the bottom, and clicks the Remove icon to unbind.

Notes

- Please use the product's own power adapter and work in the specified working environment.
- This product only supports 2.4G WIFI and does not support 5G WIFI.
- The dosing pump should be placed in a reasonable position to ensure that the height difference between the inlet and the outlet is within 0.5 m.
- The connection pipe for liquid inlet should be as short as possible, and the outlet connection pipe should be suspended above the container.
- Please check carefully that the inlet and outlet connections are in the correct direction.

Technical parameter

Dimensions (length x width x height)	60 x 95 x 83 mm (including pump head)
Weight	214g (does not include power adapter)
Power Adapter	Input: 100VAC -240VAC Output: DC12V 1A
Dosing parameters	Dosing channel: 1 KXF-B06 pump head Flow: >33ml/min Number of dosing: 24 times/day - 1 time/99 days Dosing accuracy: <±2% Volume range: 0.1ml-9999ml
Interface	WIFI
Working environment	Temperatures: 0 - 70℃ Humidity: 10% - 90% (non-condensation)
Storage environment	Temperature: -20℃ - 85℃ Humidity: 10% - 90% (non-condensation)

Packing list

No	Name	Model	Unit	Qty
1	Dosing pump	X1 PRO 2	pcs	1
2	Power adapter body	DC12V 1A	pcs	1
3	Power adapter plug	<input type="checkbox"/> US <input type="checkbox"/> UK <input type="checkbox"/> EU <input type="checkbox"/> AU	pcs	1
4	Plastic cylinder	10ml	pcs	1
5	PVC connection tube	3*5 mm; Transparent	meter	2
6	Quick start guide	English	pcs	1
8	Hanging screw	ST2.9*13	pcs	2
9	Product certification		pcs	1

Warranty service

Warranty service is only valid for users who are correctly installed, used and maintained according to the manual. Any malfunction or damage is not covered by the warranty. Please keep your purchase voucher properly so that you can get satisfactory after-sales service in time.

The company will provide free warranty service for any damage caused by manufacturing processes or components within one year from the date of purchase. The free repair service provided during the warranty period includes free repair, free replacement and replacement of faulty spare parts, and products that cannot be repaired are replaced by the same model. The free service does not include shipping costs for the product due to repairs



Kamoer Fluid Tech (Shanghai) Co., Ltd.

Address: Building 4, No. 79, Xiangjing Road, Songjiang District,
Shanghai

Website: www.kamoer.net

Kamoer is registered trademark of Kamoer Fluid Tech (Shanghai) Co., Ltd. We reserve the right to improve or alter appearance and technical specifications without notice.